

KEY

- PROPOSED KERB OR ROAD MARKING
- PROPOSED CYCLE SEGREGATION
- SEGREGATED CYCLE LANE
- FOOTWAY
- SHARED PEDESTRIAN / CYCLIST FOOTWAY
- SIGNALISED CROSSING
- CAR PARKING
- BUS LANE
- VEGETATION

NOTES

- THESE ARE ONLY CONCEPT PLANS AND WILL BE SUBJECT TO TRAFFIC MODELLING, TOPOGRAPHICAL SURVEYS AND FURTHER DETAILED DESIGN REQUIRED.
- SEGREGATED CYCLE FACILITIES WILL BE IN ACCORDANCE WITH LTN 1/20 (NATIONAL POLICY).
- CYCLE LANES WILL BE A MINIMUM WIDTH OF 1.5m.

VIEWPORT LOCATION PLAN

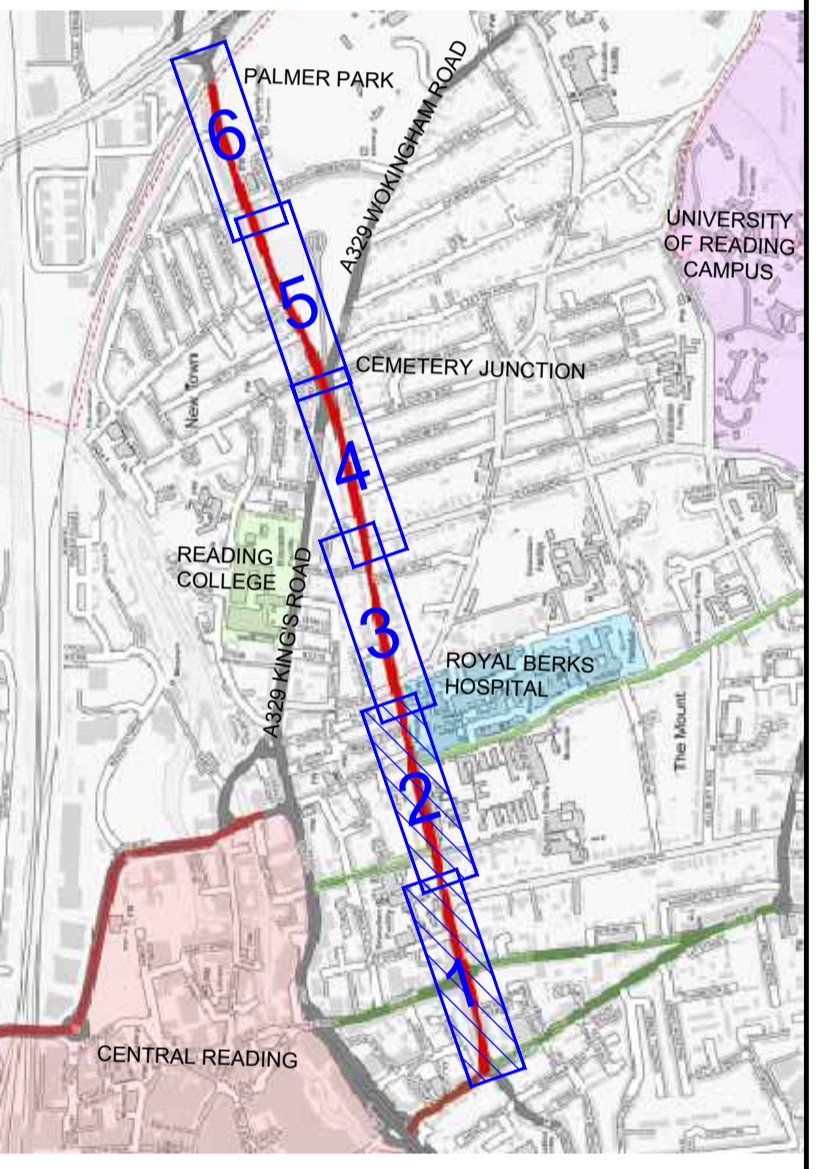

REV	DATE	BY	DESCRIPTION	CHK	APP
SO-P1	10.02.2021	LB	INITIAL ISSUE	JN	DV

CONSULTATION

70 Chancery Lane, Holborn, London, WC2A 1AF
www.wsp.com

Reading Borough Council
Working better with you

CLIENT: RBC ACTIVE TRAVEL DFT GRANT
PROJECT: SKETCH A - LONDON ROAD
TITLE: LONDON ROAD CONCEPT PROPOSAL SHEET 01 OF 03

SCALE @ A1: 1:500	DATE: 10.02.2021	DESIGN/DRAWN: LB	CHECKED: JN	APPROVED: DV	SHEET: A1
-------------------	------------------	------------------	-------------	--------------	-----------

JOB No: 70074500	PROJECT No:	Client No:	DRAWING No: 70074500-WSP-D-DR-HI-0100	REV: S0-P01
------------------	-------------	------------	---------------------------------------	-------------

C:\Users\10070601\Desktop\B02 - from the '2' watermarker-24429\London Road\70074500-WSP-D-DR-HI-0100.dwg 11 Feb, 2021 - 5:46pm

This map is reproduced from Ordnance Survey material with the permission of Ordnance Survey on behalf of the Controller of Her Majesty's Stationery Office © Crown copyright. Unauthorised reproduction infringes Crown copyright and may lead to prosecution or civil proceedings. (WCC)(LA 10009997)

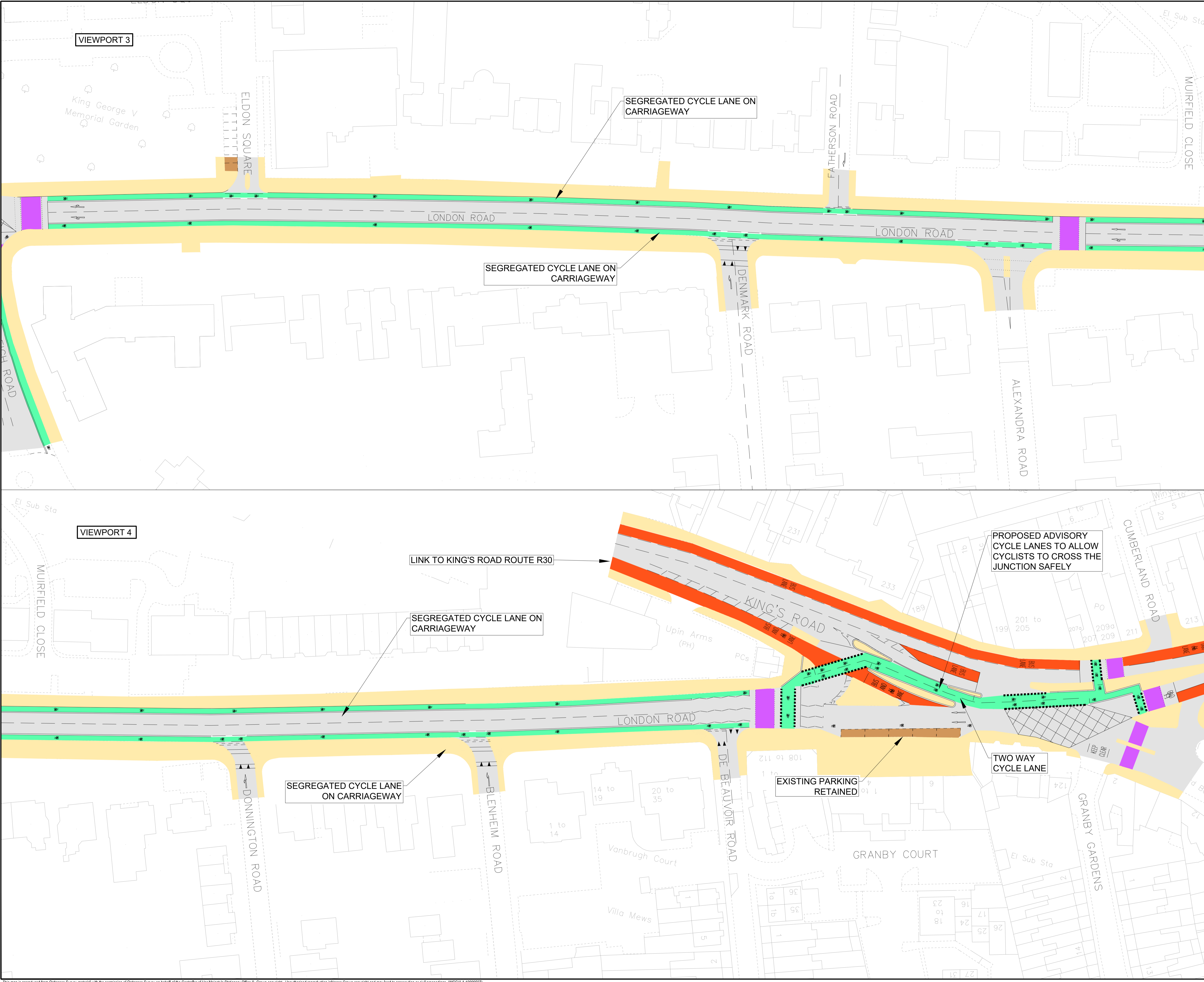

KEY

- PROPOSED KERB OR ROAD MARKING
- PROPOSED CYCLE SEGREGATION
- SEGREGATED CYCLE LANE
- FOOTWAY
- SHARED PEDESTRIAN / CYCLIST FOOTWAY
- SIGNALISED CROSSING
- CAR PARKING
- BUS LANE
- VEGETATION

NOTES

1. THESE ARE ONLY CONCEPT PLANS AND WILL BE SUBJECT TO TRAFFIC MODELLING, TOPOGRAPHICAL SURVEYS AND FURTHER DETAILED DESIGN REQUIRED.
2. SEGREGATED CYCLE FACILITIES WILL BE IN ACCORDANCE WITH LTN 1/20 (NATIONAL POLICY).
3. CYCLE LANES WILL BE A MINIMUM WIDTH OF 1.5m.

VIEWPORT LOCATION PLAN

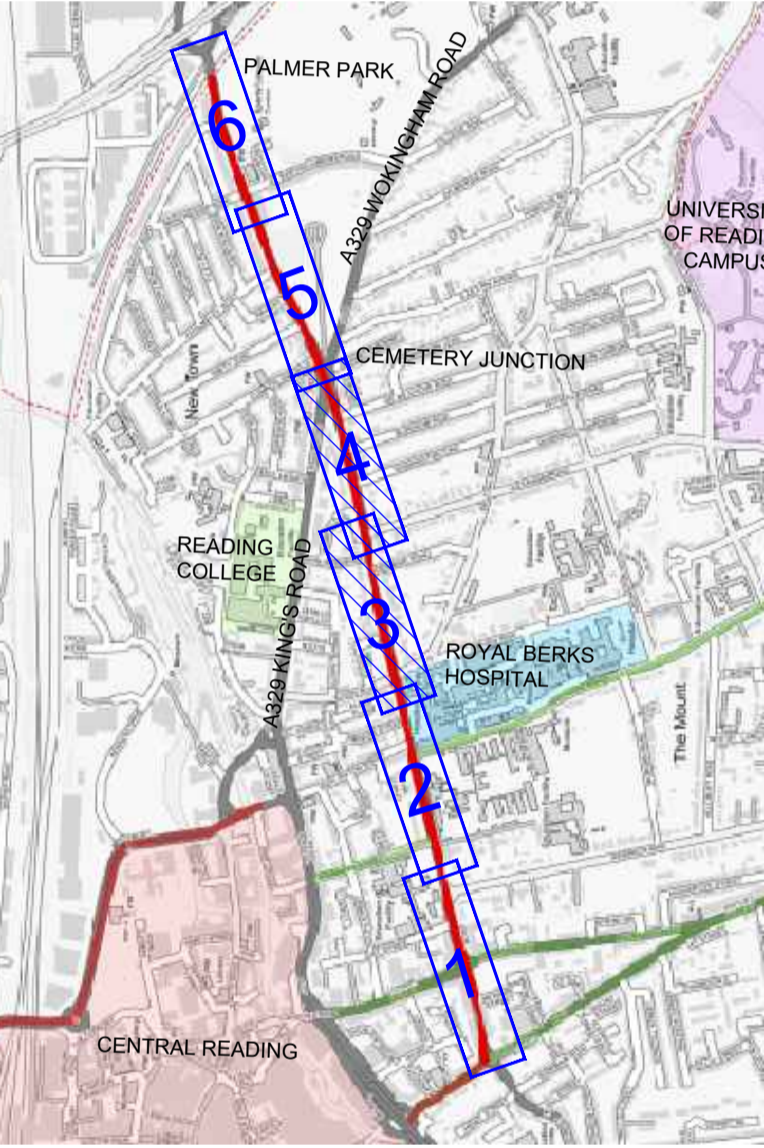

REV	DATE	BY	DESCRIPTION	CHK	APP
SO-PI	10.02.2021	LB	INITIAL ISSUE	JN	DV

CONSULTATION

70 Chancery Lane, Holborn, London, WC2A 1AF
www.wsp.com

Reading Borough Council
Working better with you

CLIENT: RBC ACTIVE TRAVEL DFT GRANT
SKETCH A - LONDON ROAD

PROJECT: LONDON ROAD
CONCEPT PROPOSAL
SHEET 02 OF 03

SCALE @ A1: 1:500	DATE: 10.02.2021	DESIGNED/DRAWN: LB	CHECKED: JN	APPROVED: DV	SHEET: A1
JOB No: 70074500	PROJECT No:	Client No:	REV: S0-P01		
DRAWING No: 70074500-WSP-D-DR-HI-0100			REV: S0-P01		

C:\Users\10070001\Desktop\WSP - From the '2' watermarker=24429\London Road\70074500-WSP-D-DR-HI-0100.dwg 11 Feb 2021 - 9:46pm
 This map is reproduced from Ordnance Survey material with the permission of Ordnance Survey on behalf of the Controller of Her Majesty's Stationery Office © Crown copyright. Unauthorised reproduction infringes Crown copyright and may lead to prosecution or civil proceedings. (WCC)(LA 10009997)



VIEWPORT 5

SEGREGATED CYCLE LANE ON FOOTWAY

VIEWPORT 6

SEGREGATED CYCLE LANE ON FOOTWAY

CONNECTION TO EXISTING READING CYCLE ROUTE R3 AT PALMER PARK

LINK TO POTENTIAL WOKINGHAM ATF SCHEME

KEY

- PROPOSED KERB OR ROAD MARKING
- PROPOSED CYCLE SEGREGATION
- SEGREGATED CYCLE LANE
- FOOTWAY
- SHARED PEDESTRIAN / CYCLIST FOOTWAY
- SIGNALISED CROSSING
- CAR PARKING
- BUS LANE
- VEGETATION

NOTES

1. THESE ARE ONLY CONCEPT PLANS AND WILL BE SUBJECT TO TRAFFIC MODELLING, TOPOGRAPHICAL SURVEYS AND FURTHER DETAILED DESIGN REQUIRED.
2. SEGREGATED CYCLE FACILITIES WILL BE IN ACCORDANCE WITH LTN 1/20 (NATIONAL POLICY).
3. CYCLE LANES WILL BE A MINIMUM WIDTH OF 1.5m.

VIEWPORT LOCATION PLAN

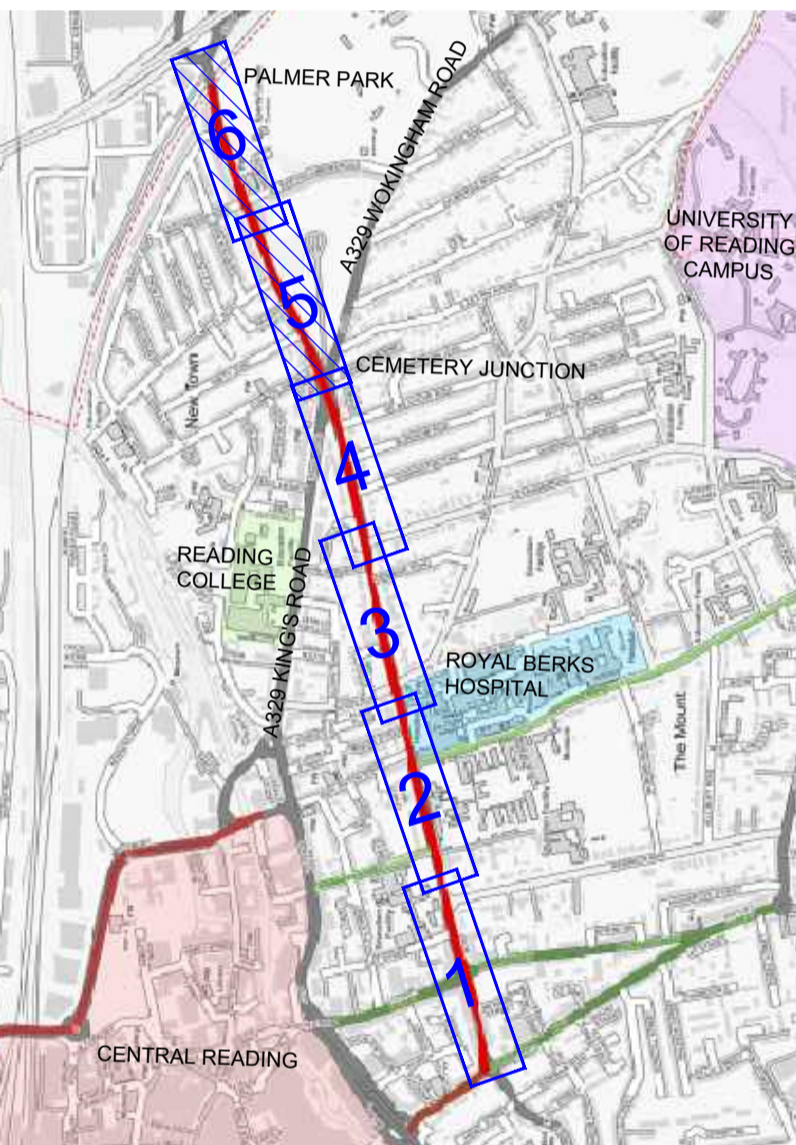

REV	DATE	BY	DESCRIPTION	CHK	APP
SO-P1	10.02.2021	LB	INITIAL ISSUE	JN	DV

DRAWING STATUS: **CONSULTATION**

70 Chancery Lane, Holborn, London, WC2A 1AF
www.wsp.com

Reading Borough Council
Working better with you

PROJECT: RBC ACTIVE TRAVEL DFT GRANT
SKETCH A - LONDON ROAD

TITLE: LONDON ROAD
CONCEPT PROPOSAL
SHEET 03 OF 03

SCALE @ A1	DATE	DESIGNED/DRAWN	CHECKED	APPROVED	SHEET
1:500	10.02.2021	LB	JN	DV	A1

JOB No: 70074500	PROJECT No:	Client No:	REV: S0-P01
---------------------	-------------	------------	----------------

DRAWING No: 70074500-WSP-D-DR-HI-0100

C:\Users\10074500\Desktop\WSP - London Road\70074500-WSP-D-DR-HI-0100.dwg 11 Feb 2021 - 14:46pm
 This map is reproduced from Ordnance Survey material with the permission of Ordnance Survey on behalf of the Controller of Her Majesty's Stationery Office © Crown copyright. Unauthorised reproduction infringes Crown copyright and may lead to prosecution or civil proceedings. (WCC/LA 10009997)