



Figure 1a - TVIA view 16 (produced by AVR London) showing the illustrative scheme from Balmore Hill

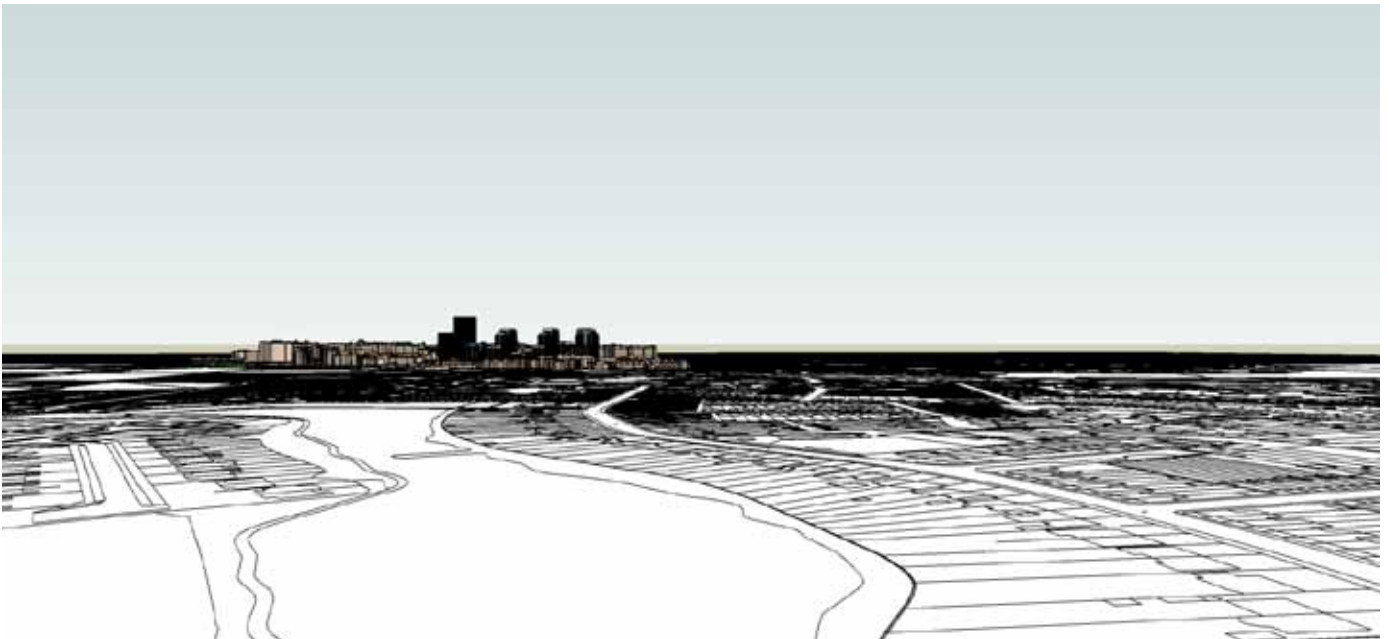

Figure 1b - View of ColladoCollins model from viewpoint 16 showing the illustrative scheme



Figure 1c - Zoomed in view of Figure 1b



Figure 1d - As figure 1c but additionally showing the proposals for SSE, Royal Mail and Station Hill sites  
Revised Image 04-05-2022



Figure 2a - TVIA view 9 (produced by AVR London) showing the illustrative scheme from Christchurch meadows



Figure 2b - View of ColladoCollins model from viewpoint 9 showing the illustrative scheme



Figure 2c - Zoomed in view of Figure 2b

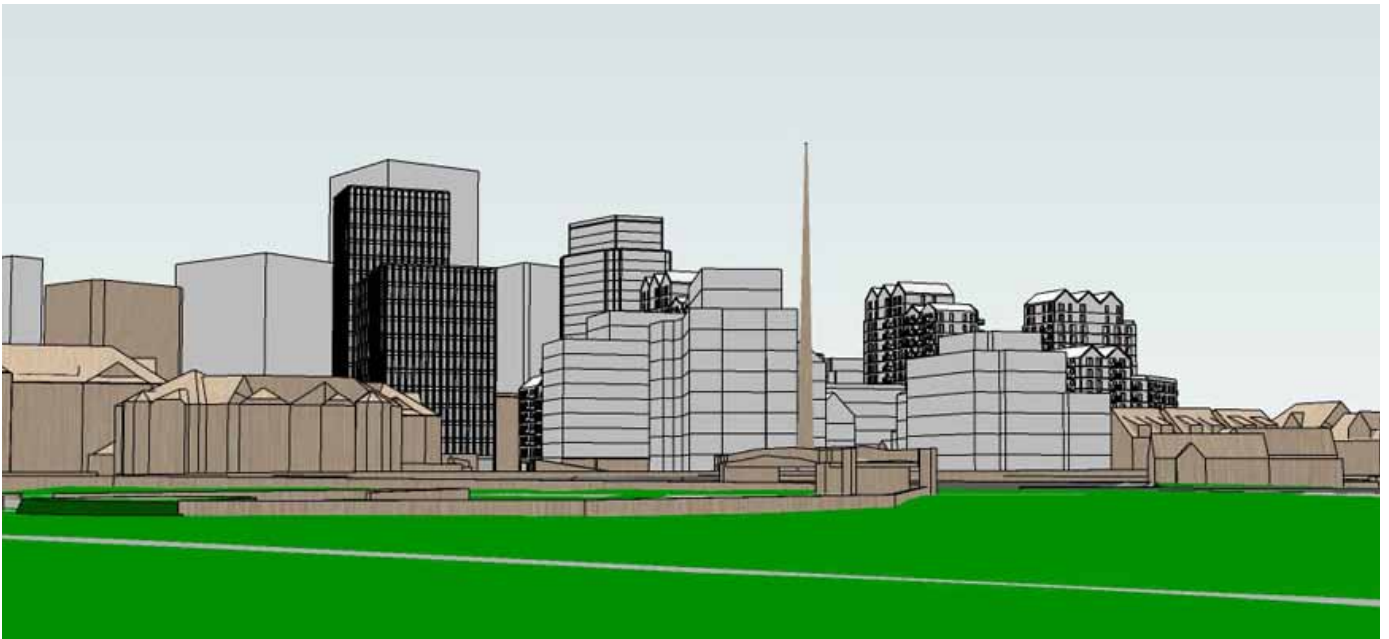

Figure 2d - As figure 2c but additionally showing the proposals for SSE, Royal Mail and Station Hill sites  
Revised Image 04-05-2022



Figure 3a - TVIA view 11 (produced by AVR London) showing the illustrative scheme from Christchurch meadows adjacent to the towpath

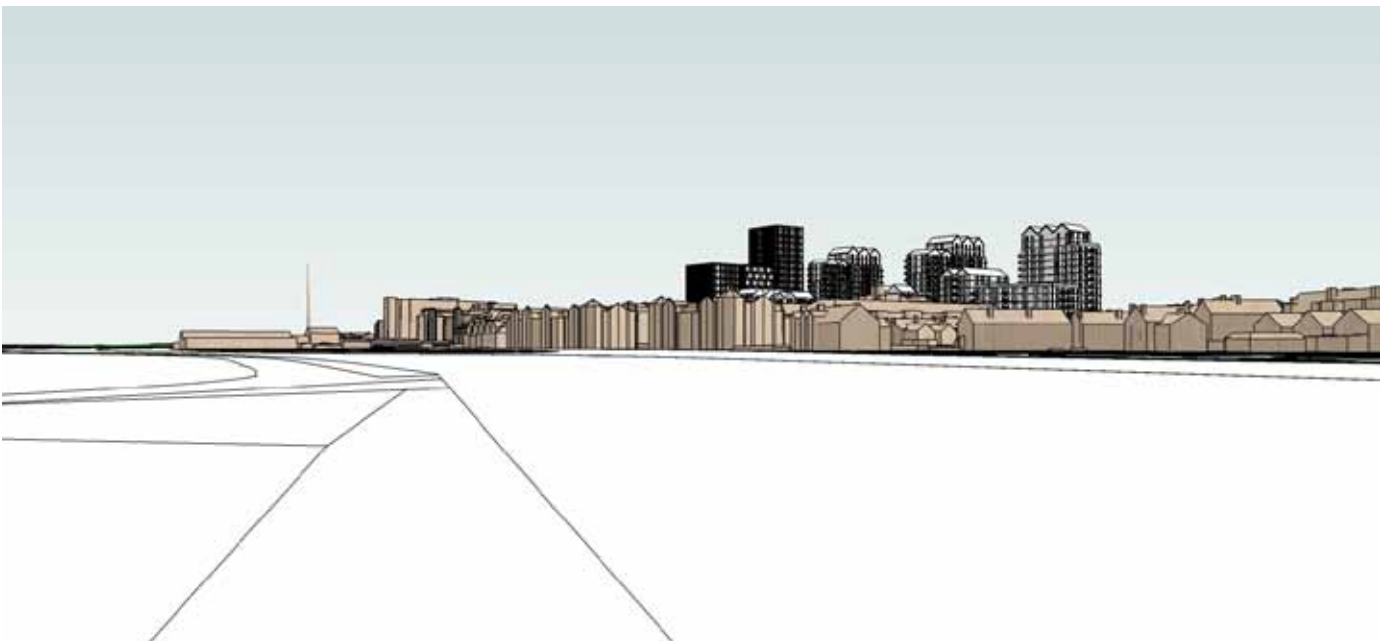

Figure 3b - View of ColladoCollins model from viewpoint 11 showing the illustrative scheme





Figure 3c - Zoomed in view of Figure 3b



Figure 3d - As figure 3c but additionally showing the proposals for SSE, Royal Mail and Station Hill sites  
Revised Image 04-05-2022



Figure 4a - View from the Forbury Rd roundabout to the South-East of the site



Figure 4b - View from the Vastern Rd roundabout to the East of the site (southern end of Reading Bridge)



Figure 5a - View along Vastern road looking South-East towards the Aviva site



Figure 5b - View along Vastern road looking North-West towards the Aviva site





Figure 6a - View from the North-South link between plots C and D looking towards the SSE site



Figure 6b - View from the SSE site looking towards the North-South link between plots C and D