

**Materials Key**

- Brick
- Tile Hung
- Render
- Black Weatherboarding
- Red Roof Tile
- Grey Roof Tile
- Brown Roof Tile

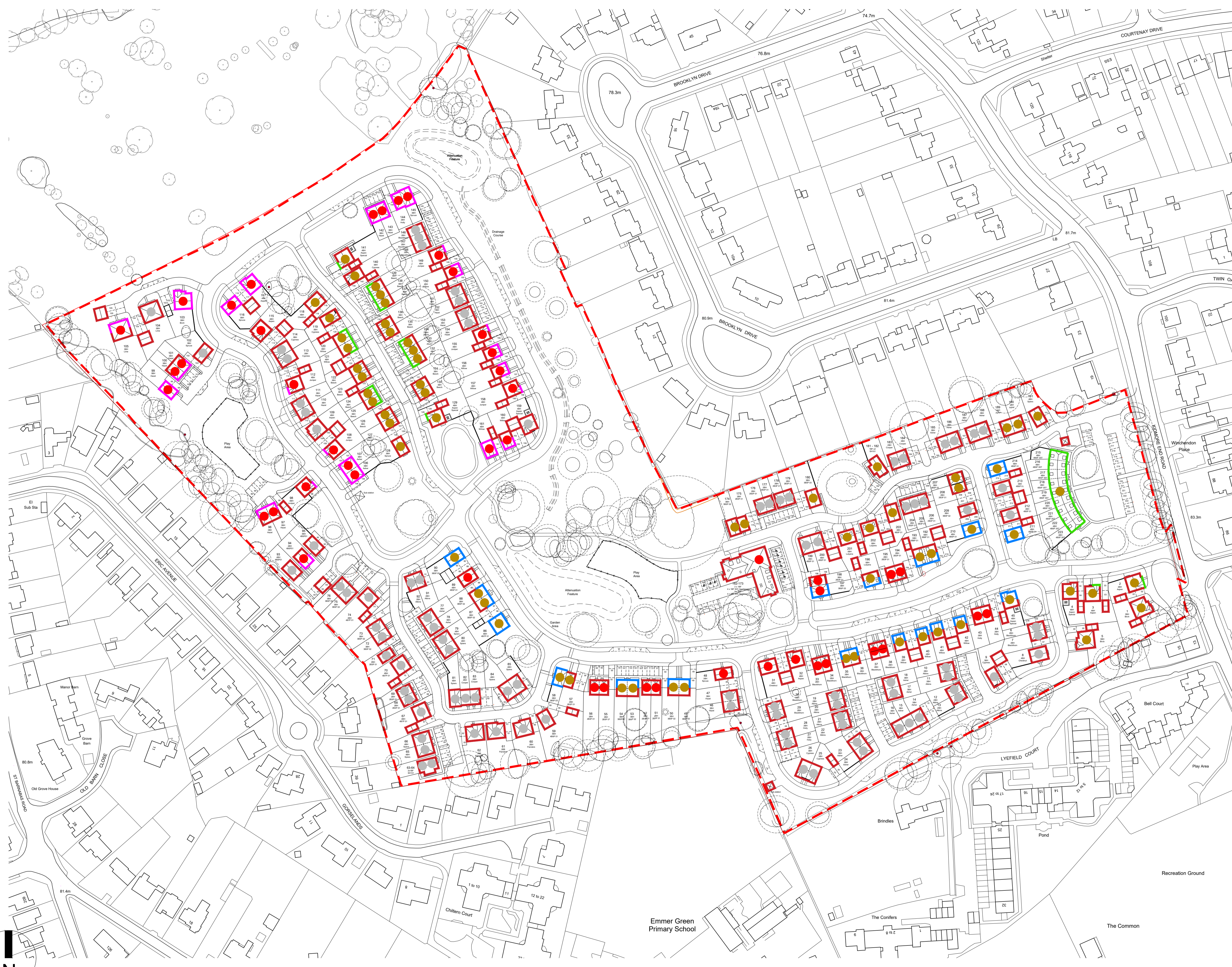

Rev	Date	Revision Details	Dr	Ch
EI	08.09.22	Minor material designation amendment	MP	NF
Surf	02.09.22	Minor material alterations	RG	MP
D	22.06.22	Minor material alterations	MP	NF
C	14.06.22	Plot handing updated	NF	MP
B	10.06.22	Amendments to site layout	MP	NF
A	10.06.22	Amendments to site layout	MP	NF



**London:** 76 Great Suffolk Street, London, SE1 0BL  
 T 0207 928 2773 E london@ecearchitecture.com  
**Sussex:** Brooklyn Chambers, 11 Goring Road, Worthing, West Sussex, BN12 4AP  
 T 01903 248777 E sussex@ecearchitecture.com  
**Bristol:** Westworks, Colston Tower, Colston Street, Bristol, BS1 4XE  
 T 0117 214 1101 E bristol@ecewestworks.com  
**ECE Architecture**  
 www.ecearchitecture.com

Client's Name  
**Vistry Group**

Job Title  
**Reading Golf Club  
Kidmore End Road, Reading**

Drawing Title  
**Materials Plan**

Scale  
**1:1000 @ A1 / 1:2000 @ A3**



Drawn	Checked	Date
RG	MP	01.10.21

Job No	Drawing No	Rev
6960	PL-055	E

Status  
**APPROVAL**